

## 6.40 Double disc brake type DSB



Double disc brake manual



Double disc brake pneumatic



Double disc brake with membrane cylinder I for sensitive control



Double disc brake with membrane cylinder II for sensitive control

	DSB manual	DSB pneumatic	DSB membrane I	DSB membrane II
<b>type 30-40</b>				
performance kW (h.p.)	0.6 (0.45)	0.6 (0.45)	0.6 (0.45)	0.6 (0.45)
min. brake torque Nm (ft/lb)	8 (5.79)	20 (14)	10 (7)	30 (22)
max. brake torque Nm (ft/lb)	200 (140)	200 (140)	200 (140)	440 (320)
<b>type 40-50</b>				
performance kW (h.p.)	0.6 (0.45)	0.6 (0.45)	0.6 (0.45)	0.6 (0.45)
min. brake torque Nm (ft/lb)	8 (5.79)	20 (14)	10 (7)	30 (22)
max. brake torque Nm (ft/lb)	200 (140)	200 (140)	200 (140)	440 (320)
<b>type 50-80</b>				
performance kW (h.p.)	0.6 (0.45)	0.6 (0.45)	0.6 (0.45)	0.6 (0.45)
min. brake torque Nm (ft/lb)	8 (5.79)	20 (14)	10 (7)	30 (22)
max. brake torque Nm (ft/lb)	200 (140)	200 (140)	200 (140)	440 (320)

Form for calculation and enquiries see chapter 9.00

### Foot mounted chuck with double disc brake manual

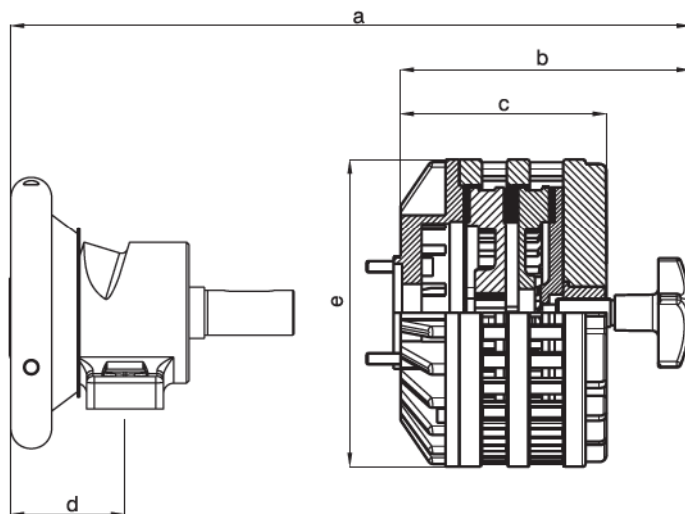

picture of chuck just symbolic

	a	b	c	d	e
ST 30 - 40 + DSB manual	352	212	147	90	Ø 220
ST 40 - 50 + DSB manual	402.5	212	147	84	Ø 220
ST 50 - 80 + DSB manual	472	212	147	124	Ø 220

### Flange mounted chuck with double disc brake manual

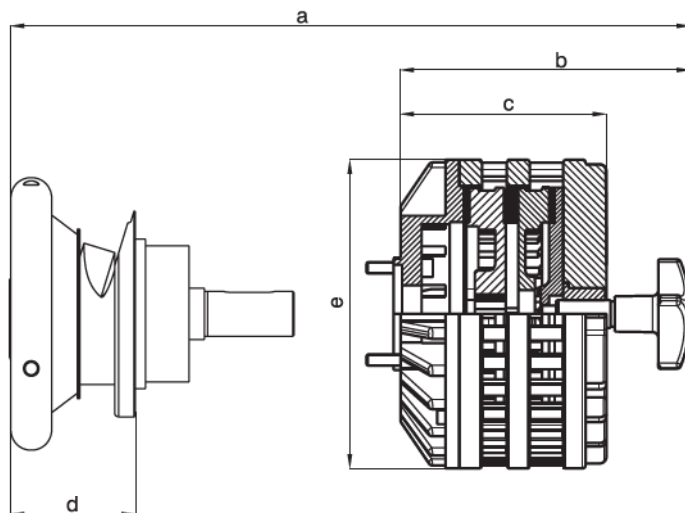

picture of chuck just symbolic

	a	b	c	d	e
FL 30 - 40 + DSB manual	352	212	147	98	Ø 220
FL 40 - 50 + DSB manual	402.5	212	147	130	Ø 220
FL 50 - 80 + DSB manual	472	212	147	200	Ø 220

Dimension schedule for Boschert-Chuck see chapter 2.30 - 2.50  
 Schedule for dimension diagram see page 5.52

## Foot mounted chuck with double disc brake pneumatic

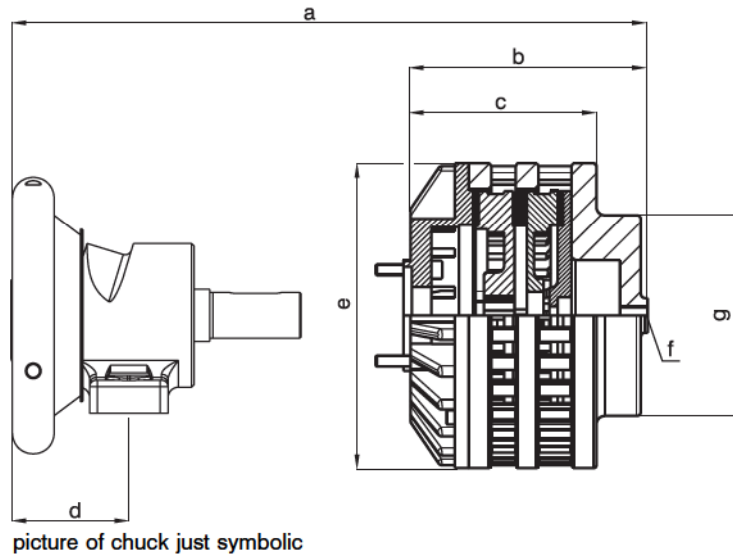

	a	b	c	d	e	f	g
<b>ST 30 - 40 + DSB pneumatic</b>	310	170	165	90	Ø 220	G 1/4	Ø 145
<b>ST 40 - 50 + DSB pneumatic</b>	360.5	170	165	84	Ø 220	G 1/4	Ø 145
<b>ST 50 - 80 + DSB pneumatic</b>	430	170	165	124	Ø 220	G 1/4	Ø 145

## Flange mounted chuck with double disc brake pneumatic

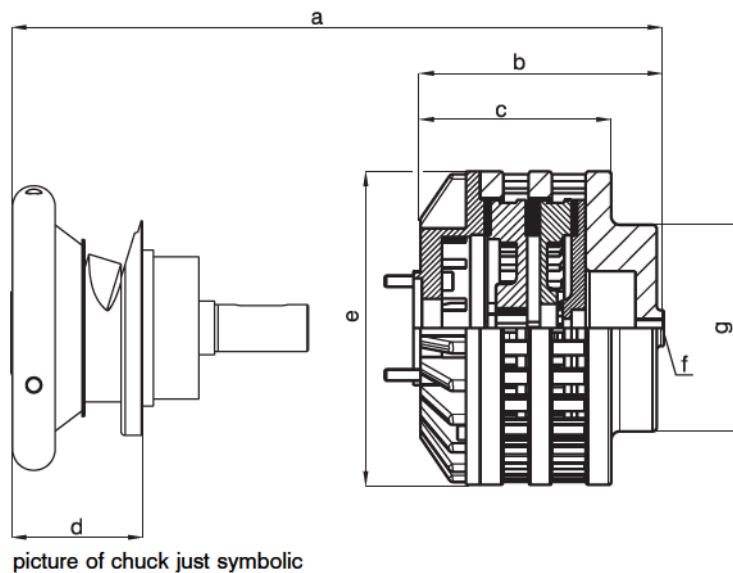

	a	b	c	d	e	f	g
<b>FL 30 - 40 + DSB pneumatic</b>	310	170	165	98	Ø 220	G 1/4	Ø 145
<b>FL 40 - 50 + DSB pneumatic</b>	360.5	170	165	130	Ø 220	G 1/4	Ø 145
<b>FL 50 - 80 + DSB pneumatic</b>	430	170	165	200	Ø 220	G 1/4	Ø 145

Dimension schedule for Boschert-Chuck see chapter 2.30 - 2.50  
 Schedule for dimension diagram see page 5.52

# DSB and membrane cylinder I



## Foot mounted chuck with double disc brake and membrane cylinder I

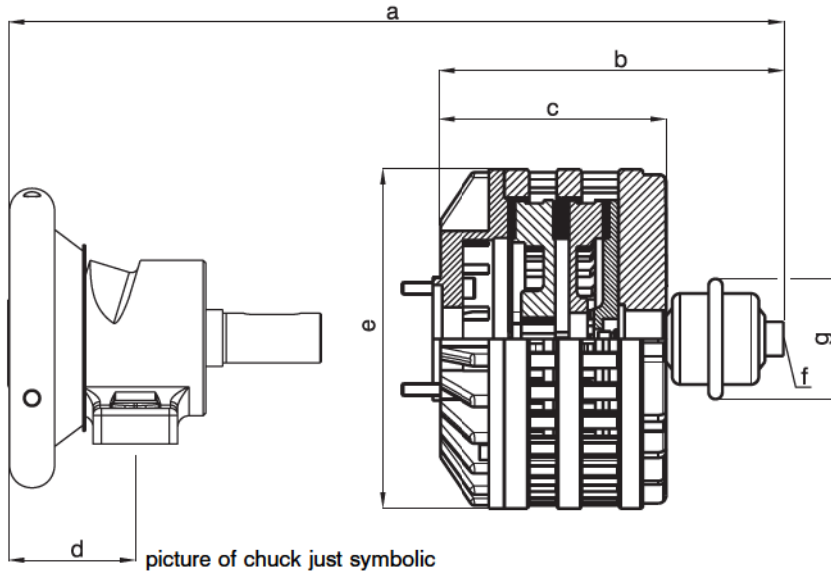

	a	b	c	d	e	f	g
ST 30 - 40 + DSB membrane I	363	223	146	90	Ø 220	G 1/4	Ø 78
ST 40 - 50 + DSB membrane I	413.5	223	146	84	Ø 220	G 1/4	Ø 78
ST 50 - 80 + DSB membrane I	483	223	146	124	Ø 220	G 1/4	Ø 78

## Flange mounted chuck with double disc brake and membrane cylinder I

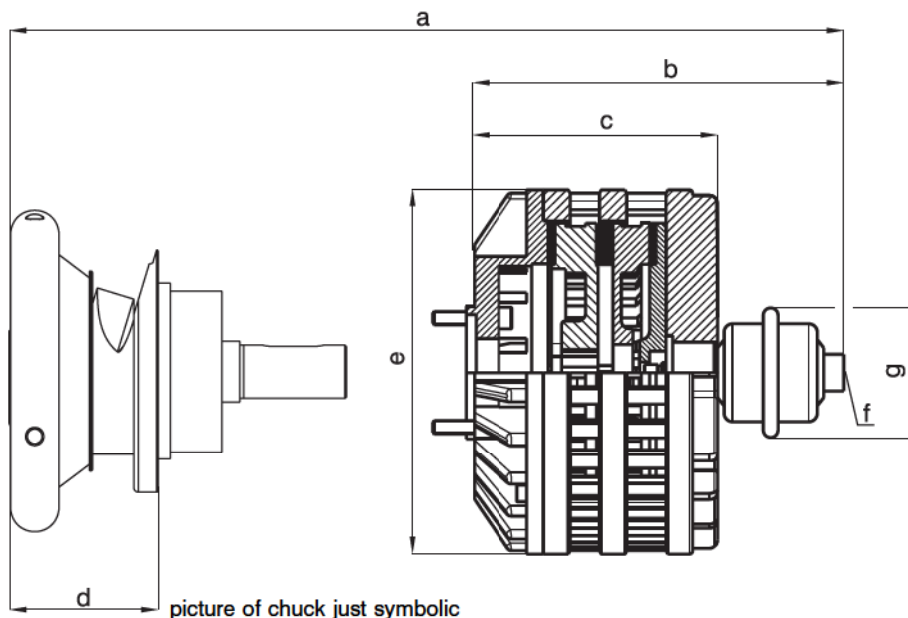

	a	b	c	d	e	f	g
FL 30 - 40 + DSB membrane I	363	223	146	98	Ø 220	G 1/4	Ø 78
FL 40 - 50 + DSB membrane I	413.5	223	146	130	Ø 220	G 1/4	Ø 78
FL 50 - 80 + DSB membrane I	483	223	146	200	Ø 220	G 1/4	Ø 78

Dimension schedule for Boschert-Chuck see chapter 2.30 - 2.50  
Schedule for dimension diagram see page 5.52

# DSB and membrane cylinder II

## Foot mounted chuck with double disc brake and membrane cylinder II

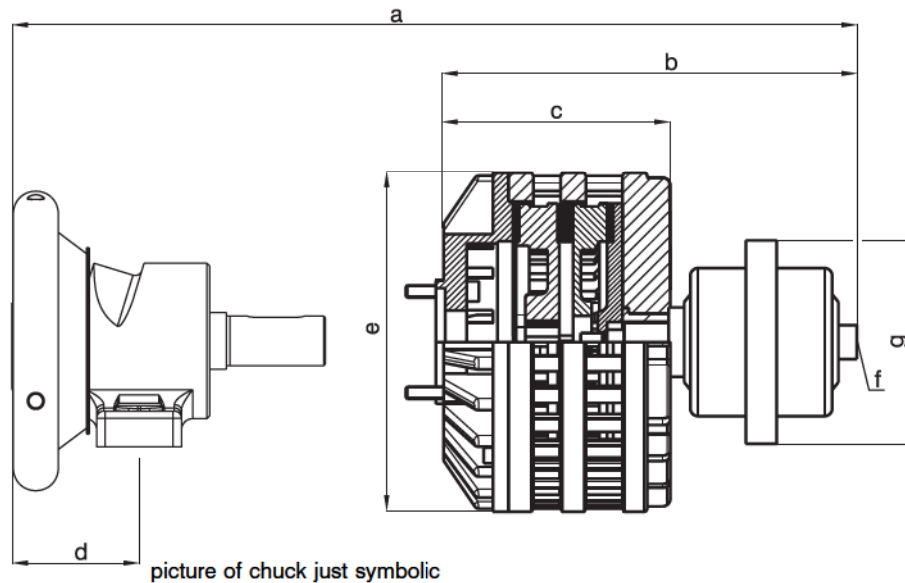

	a	b	c	d	e	f	g
ST 30 - 40 + DSB membrane II	423	283	146	90	Ø 220	G 1/4	Ø 132
ST 40 - 50 + DSB membrane II	473.5	283	146	84	Ø 220	G 1/4	Ø 132
ST 50 - 80 + DSB membrane II	543	283	146	124	Ø 220	G 1/4	Ø 132

## Flange mounted chuck with double disc brake and membrane cylinder II

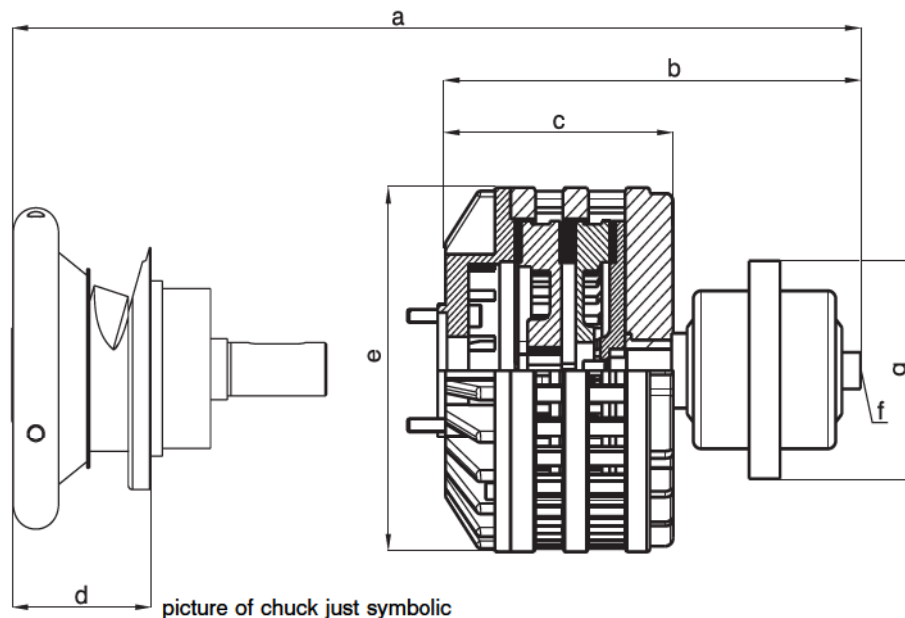

	a	b	c	d	e	f	g
FL 30 - 40 + DSB membrane II	423	283	146	98	Ø 220	G 1/4	Ø 132
FL 40 - 50 + DSB membrane II	473.5	283	146	130	Ø 220	G 1/4	Ø 132
FL 50 - 80 + DSB membrane II	543	283	146	200	Ø 220	G 1/4	Ø 132

Dimension schedule for Boschert-Chuck see chapter 2.30 - 2.50  
Schedule for dimension diagram see page 5.52

# Overall dimension DSB with Sliding-, A- and P-chuck

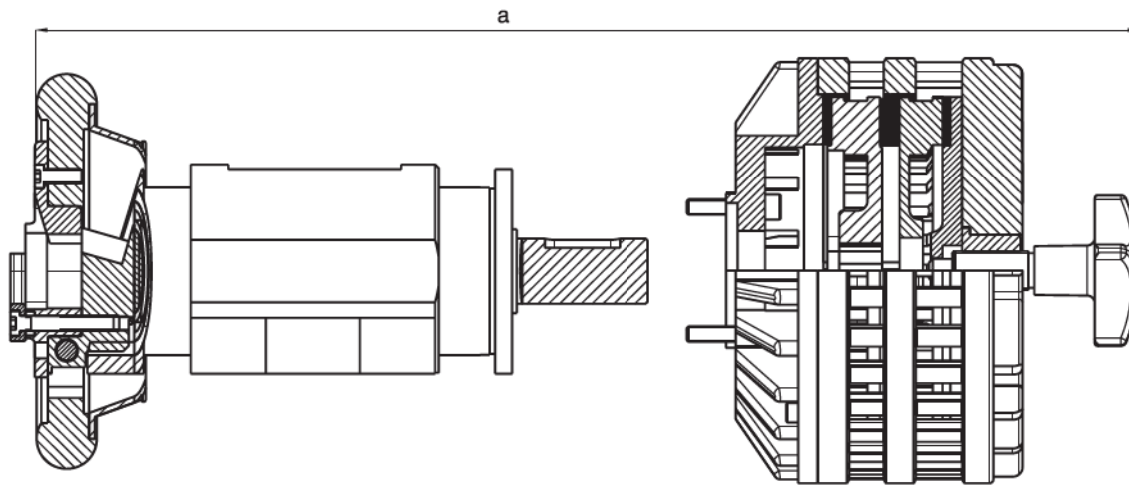

picture of chuck and brake just symbolic

overall dimension „a“  
for Boschert Sliding -, A- and P-Chuck (flange- and foot mounted chuck)

	DSB manual	DSB pneumatic	DSB membrane I	DSB membrane II	chuck dim. on page
<b>brake dim. on page</b>	<b>6.41</b>	<b>6.42</b>	<b>6.43</b>	<b>6.44</b>	
<b>Sliding-Chuck</b>					3.03 - 3.06
<b>30-40</b>					
50 mm adjustment	469	427	540	540	
100 mm adjustment	569	527	640	640	
<b>40-50</b>					
50 mm adjustment	475	433	546	546	
100 mm adjustment	575	426	646	646	
<b>A Chuck</b>					
A40	365	325	375	435	4.21 - 4.22
A50	412	370	423	483	4.31 - 4.32
A80	492	450	503	563	4.41 - 4.42
<b>P Chuck</b>					
P40	432	390	503	503	4.61 - 4.62
P50	468	426	539	539	4.71 - 4.72

A Chucks = A Series Pneumatic Safety Chucks  
P Chucks = P Series Pneumatic Safety Chucks

# DSB performance diagrams type 30-40/40-50/50-80

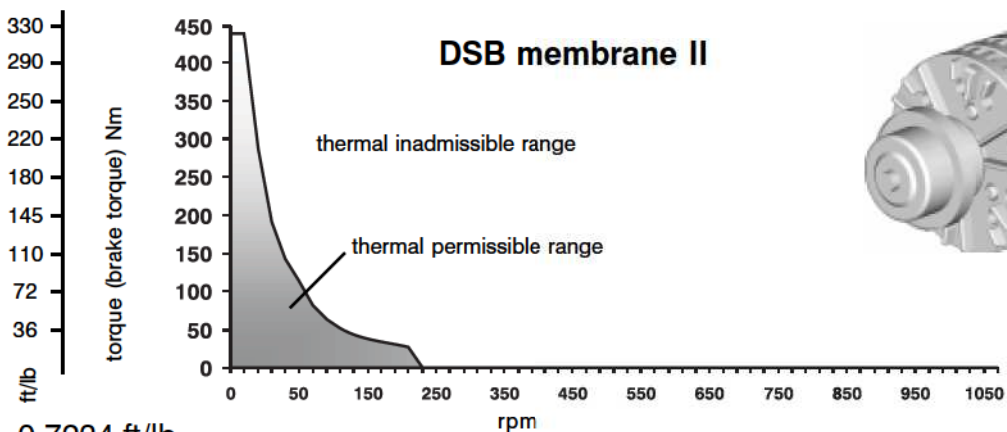
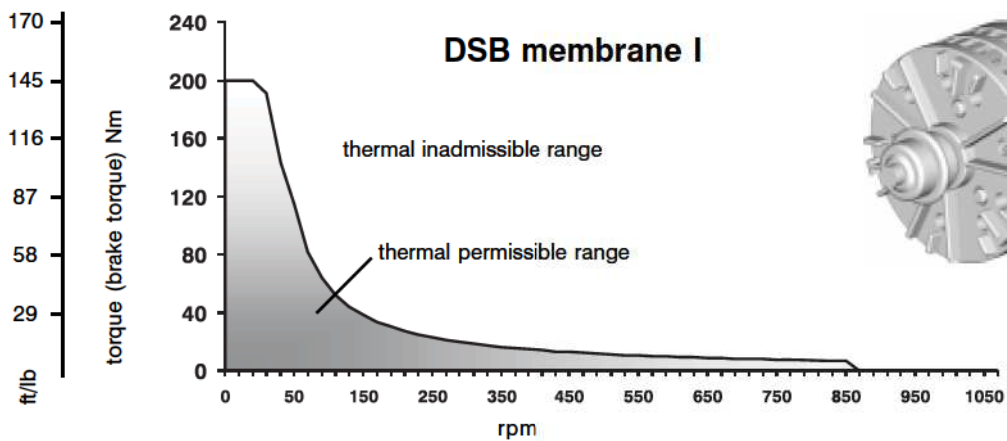
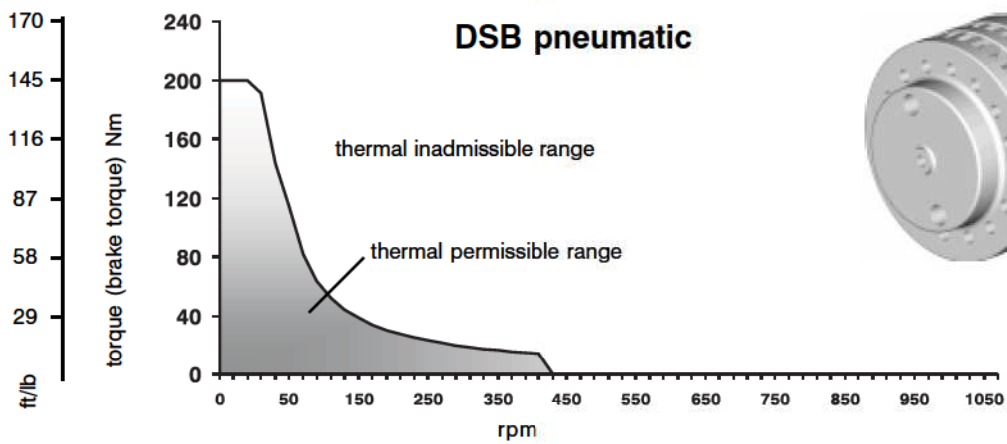
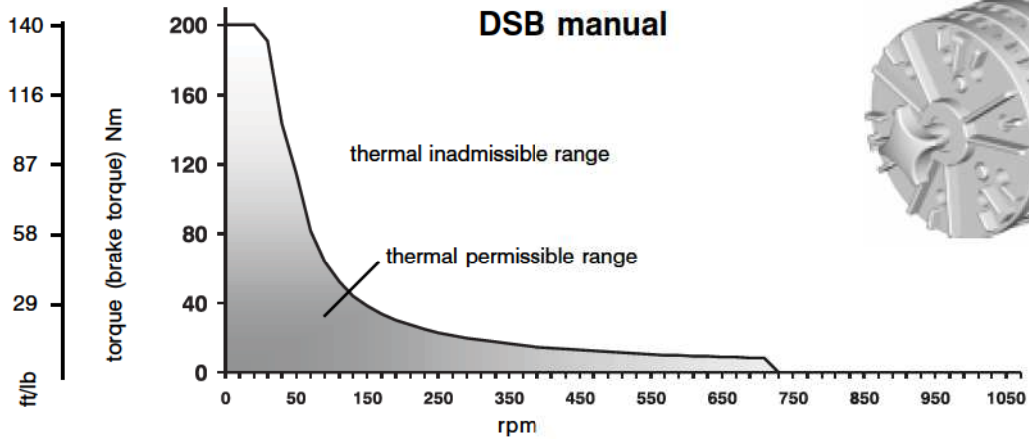

1 Nm = 0.7234 ft/lb

Mattenstraße 1  
79541 Lörrach-Hauingen

infokl@boschert.de  
www.boschert.de

Tel.: 07621 / 95 93 24 - 26  
Fax: 07621 / 55 184

6.46

# DSB wearing-parts

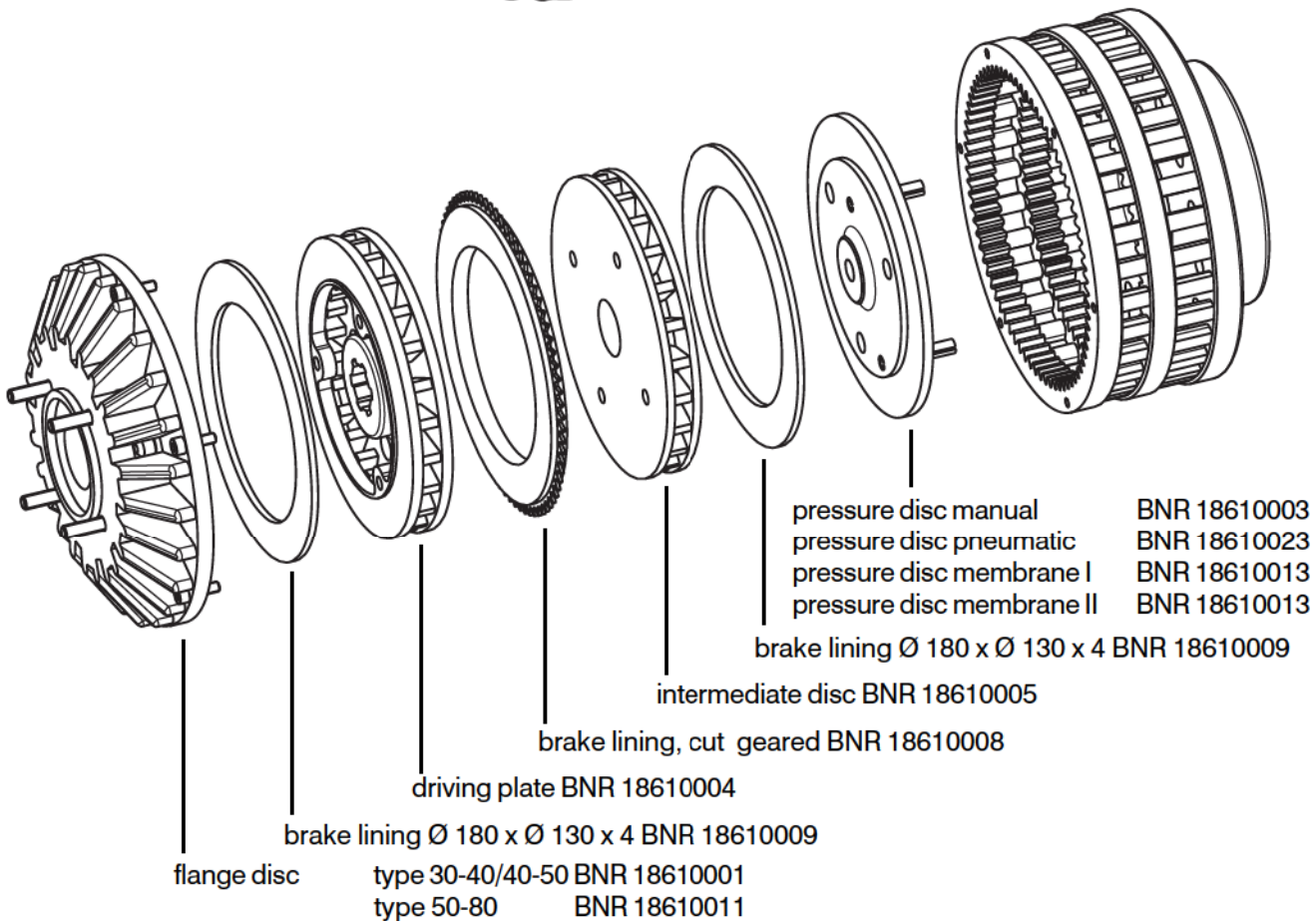
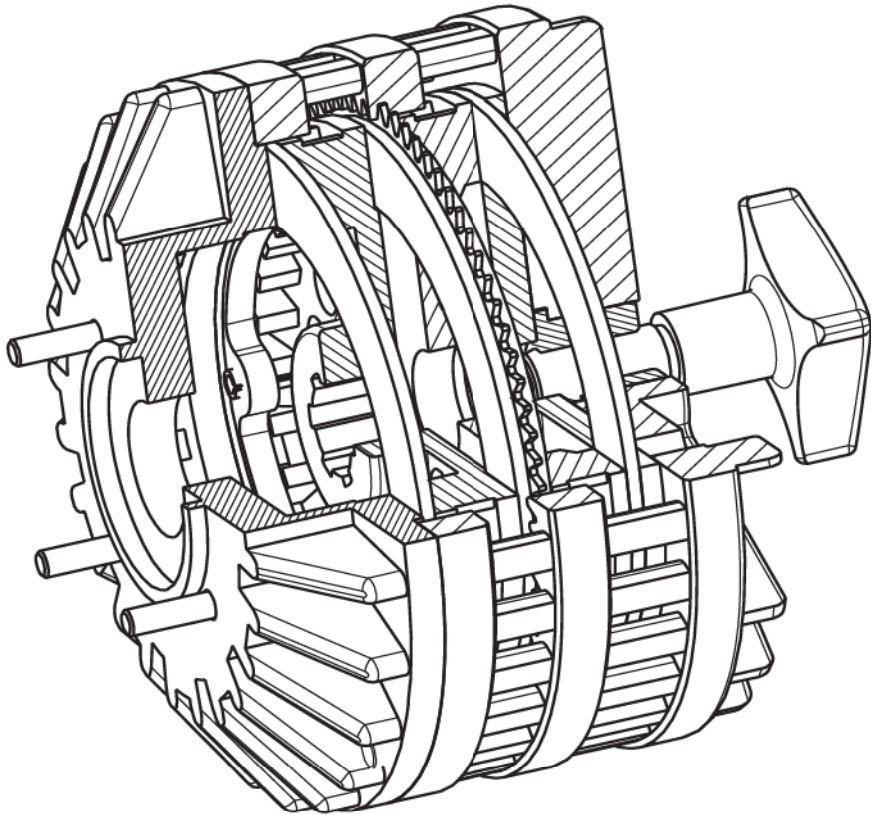

6.47

Mattenstraße 1  
79541 Lörrach-Hauingen

infokl@boschert.de  
www.boschert.de

Tel.: 07621 / 95 93 24 – 26  
Fax: 07621 / 55 184

Changes reserved (b)